

AG30
1022
0012

C11 AND C13 GEAR OIL PUMPS INSTRUCTION MANUAL



Introduction

Thank you for purchasing either a Macnaught model C11 or C13 Gear Oil Pump.

Models C11 and C13 are supplied complete with hose assembly and nozzle. Other models available are CF11 and CF13, which are supplied standard with hose, filter and nozzle assembly.

Please read and retain this instruction sheet to assist you in the maintenance of this quality product.

IMPORTANT

Before operation ensure that manual non-drip nozzle is open to prevent pressure build up or hose damage.

FEATURES

- * C11 Fits 205 Litre Drums
- * C13 Fits 60 Litre Drums
- * Suitable for oils up to SAE 140
- * Delivers approximately 75ml / stroke
- * Optional CF strainer available

DESCRIPTION

The C11 and C13 pumps are designed specifically for pumping heavier grade gear oils (to SAE 140). Both models deliver approximately 75mls per stroke.

An optional (CF) strainer is available for pumping transmission fluids and hydraulic oils.

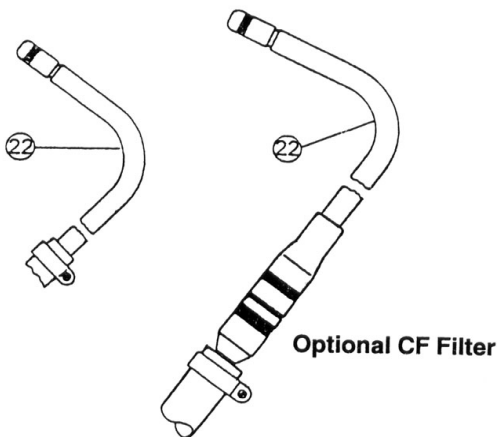

TROUBLE SHOOTING

TROUBLE	CAUSE	REMEDY
Hard to pump	a) Gland nut is screwed down too tightly.	a) Adjust gland nut
	b) Bent piston rod	b) Replace piston rod and piston assembly
Pump fails to prime	a) Footvalve ball is not seating properly.	a) Remove the footvalve assembly from the pump and clean.
	b) Piston valve ball is not seating or the piston "o"ring" is damaged.	b) Clean piston assembly and replace the piston "o"ring" if required.

PARTS DIAGRAM

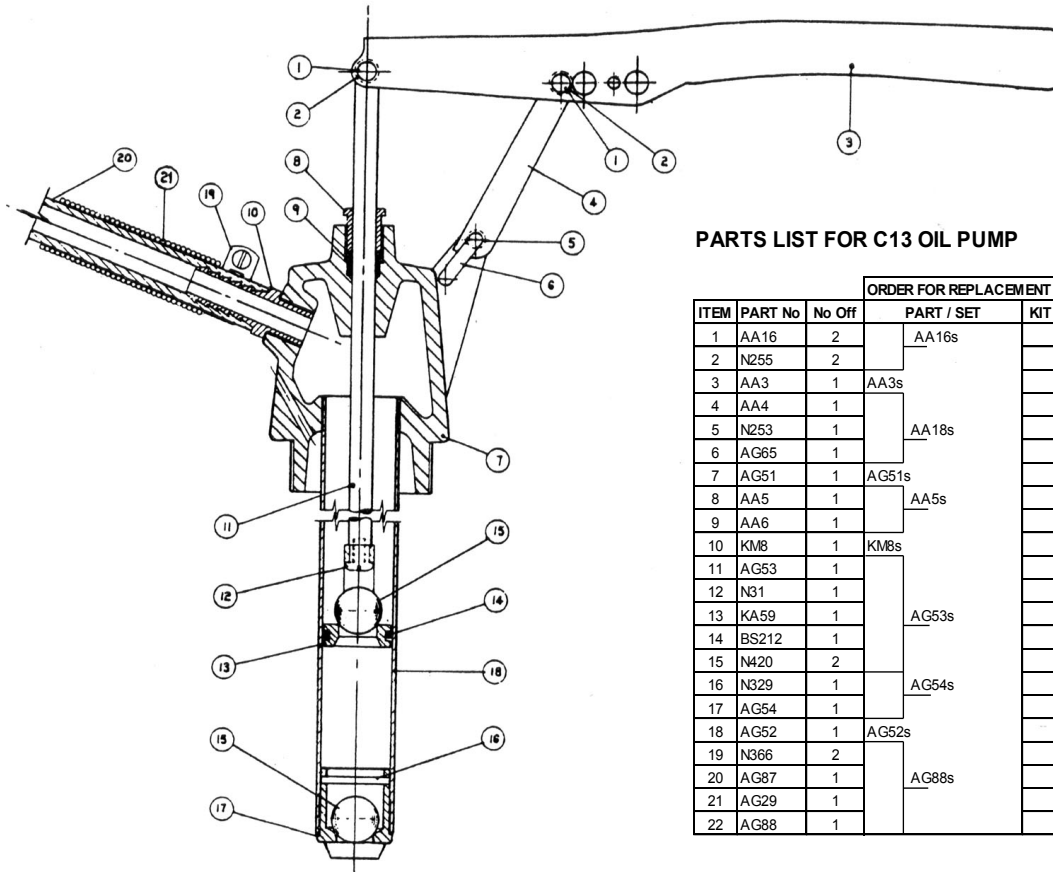

PARTS LIST FOR C13 OIL PUMP

ITEM	PART No	No Off	ORDER FOR REPLACEMENT		DESCRIPTION
			PART / SET	KIT REF	
1	AA16	2	AA16s		PIVOT PIN
2	N255	2			PIVOT PIN RETAINER
3	AA3	1	AA3s		HANDLE
4	AA4	1			HANDLE LINK
5	N253	1	AA18s		RATCHET PLATE
6	AG65	1			HOSE HANGER PIVOT
7	AG51	1	AG51s		BODY
8	AA5	1	AA5s		GLAND NUT
9	AA6	1			GLAND PACKING
10	KM8	1	KM8s		HOSE TAIL
11	AG53	1			PISTON ROD
12	N31	1			SCREW
13	KA59	1	AG53s		PISTON
14	BS212	1			"O"RING
15	N420	2			19mm STEEL BALL
16	N329	1	AG54s		FOOTVALVE PIN
17	AG54	1			FOOTVALVE
18	AG52	1	AG52s		PUMP TUBE
19	N366	2			HOSE CLAMP
20	AG87	1	AG88s		HOSE 12.7mm x 1.84mm LONG
21	AG29	1			HOSE SPRING
22	AG88	1			OUTLET TUBE ASSEMBLY

PARTS LIST FOR C11 OIL PUMP

ITEM	PART No	No Off	ORDER FOR REPLACEMENT		DESCRIPTION
			PART / SET	KIT REF	
1	AA16	2	AA16s		PIVOT PIN
2	N255	2			PIVOT PIN RETAINER
3	AA3	1	AA3s		HANDLE
4	AA4	1			HANDLE LINK
5	N253	1	AA18s		RATCHET PLATE
6	AG65	1			HOSE HANGER PIVOT
7	AG51	1	AG51s		BODY
8	AA5	1	AA5s		GLAND NUT
9	AA6	1			GLAND PACKING
10	KM8	1	KM8s		HOSE TAIL
11	AG43	1			PISTON ROD
12	N31	1			SCREW
13	KA59	1	AG43s		PISTON
14	BS212	1			"O"RING
15	N420	2			19mm STEEL BALL
16	N329	1	AG54s		FOOTVALVE PIN
17	AG54	1			FOOTVALVE
18	AG42	1	AG42s		PUMP TUBE
19	N366	2			HOSE CLAMP
20	AG87	1	AG88s		HOSE 12.7mm x 1.84mm LONG
21	AG29	1			HOSE SPRING
22	AG88	1			OUTLET TUBE ASSEMBLY



Macnaught Pty Limited
ABN 66 000 075 785

41-49 Henderson Street
Turrella NSW 2205 Sydney Australia
Postal Address PO Box 90
Amcliffe NSW 2205 Sydney Australia

T: +61 2 9567 0401
F: +61 2 9597 7773
W: www.macnaught.com.au

For Warranty Terms and Conditions see macnaught.com.au
For a list of Australian Service Centres see macnaught.com.au